

EMX 9 M025

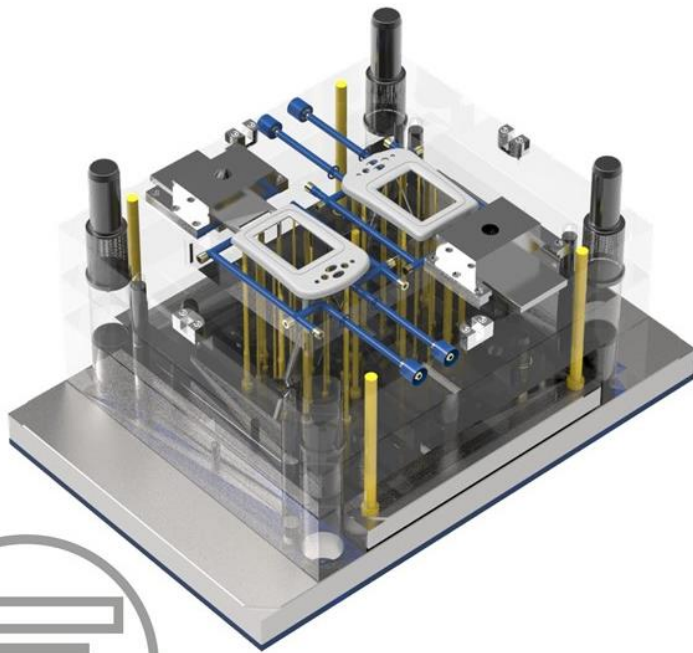

What's New?

- Enhancements
- Components



Enhancements

Enhancement 1

Edit additional angle value for rotation fixture of blade ejector pins.
Works for HASCO Z46 only

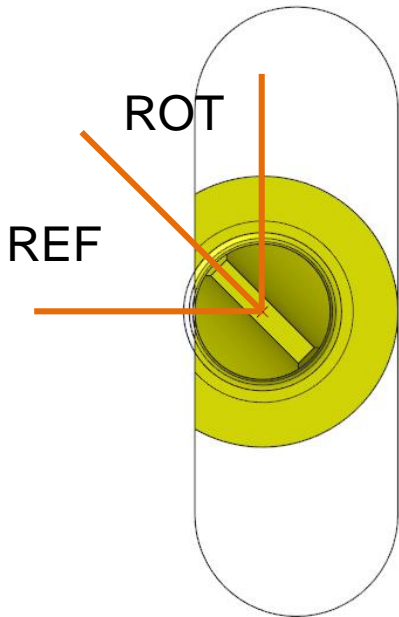

REF_ANGLE
i.e. 45°

ROT_ANGLE
i.e. additional 45°

Dimension Name	Value
SIZE-Size	5.5x1
LG1-Length	160
LG2-Shoulder Hei...	80.0
REF_ANGLE-Angle	45

Dimension N...	Value	Tolerances	Rule
F	0.300		0.3
A	60.000		60
OFF	3.000		0.5
CD_SKETCH	12.000		DM
ROT_ANGLE	45.000		0

Enhancements

Enhancement 2

New Option

ALLOW_SIZE_EDIT.

- Set custom mold base width and length for non standard plates.
- Patterns need to be edited manually

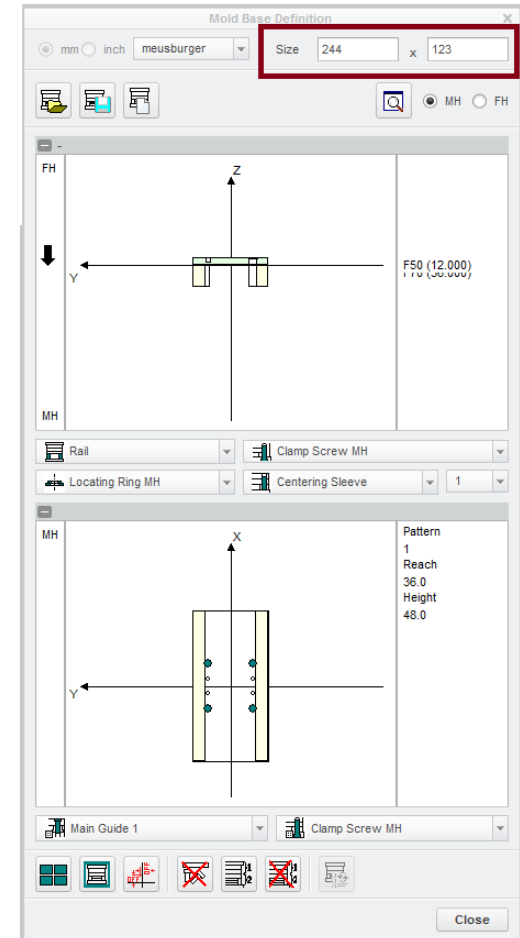
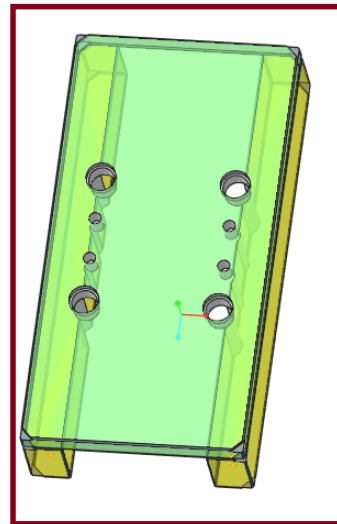

Enhancements

- Enhanced Search for Library components
- Allow usage of <user_number> as placeholder in part names definition
- Allow adding of comp subassemblies in "Modify Project" if NAME_SUBASM_COMP is not "-,"
- Consider insulation thickness for total mold base height shown in Mold Base Definition
- BOM: Show how many objects were found with search panel

Additional Info

Join the PTC User Community!

You will find:

- Discussions
- Videos
- Blog posts

PTC User Community EMX Group

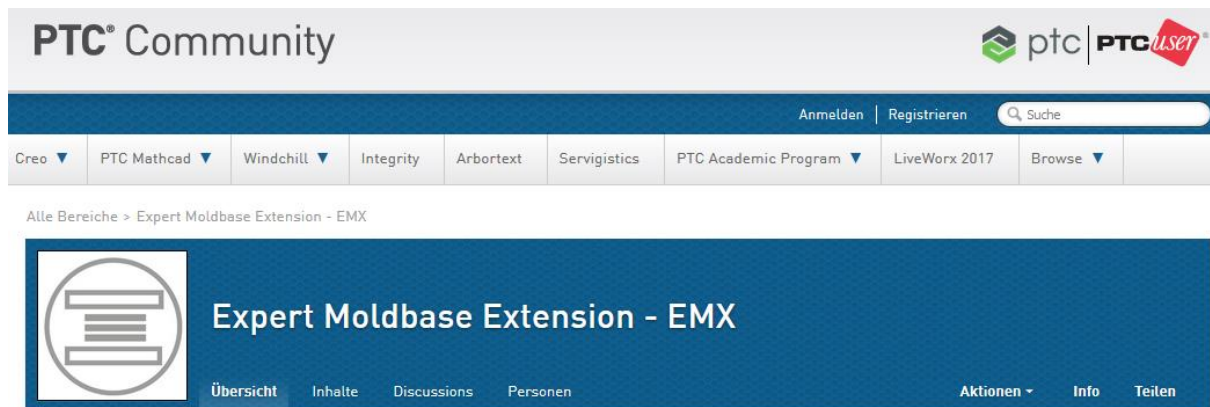

The screenshot shows the PTC Community website interface. At the top left is the "PTC® Community" logo. To the right are the "ptc" and "PTC UserSet" logos. Below the header is a navigation bar with links for "Anmelden" and "Registrieren", and a search bar labeled "Suche". A secondary navigation bar lists various software categories: "Creo", "PTC Mathcad", "Windchill", "Integrity", "Arbortext", "Servigistics", "PTC Academic Program", "LiveWorx 2017", and "Browse". Below this, the breadcrumb "Alle Bereiche > Expert Moldbase Extension - EMX" is visible. The main content area features a blue header for the "Expert Moldbase Extension - EMX" group, which includes a circular icon with horizontal lines. Below the group name are navigation tabs for "Übersicht", "Inhalte", "Discussions", and "Personen". At the bottom right of the group header are links for "Aktionen", "Info", and "Teilen".