

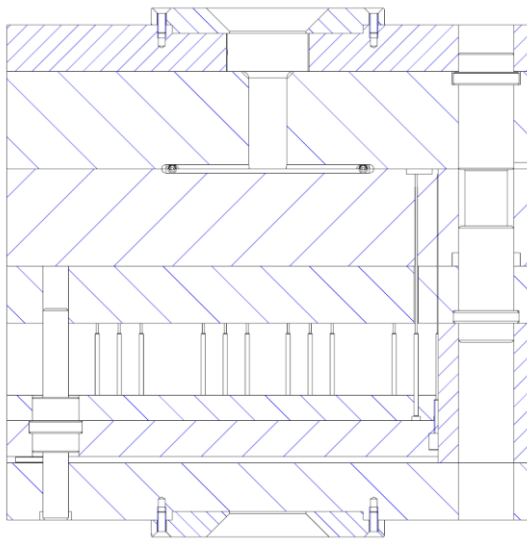

# SMARTXHatch



## X-hatch Management for Assemblies and Drawings

**SMART – FAST – ROBUST**

Integrated in

creo® parametric

### You like to ...

- ... save time on defining cross hatchings in your drawing
- ... keep your hatchings in sync between assembly and drawing
- ... use simple rules for defining the hatching properties
- ... preview the result prior to view regeneration

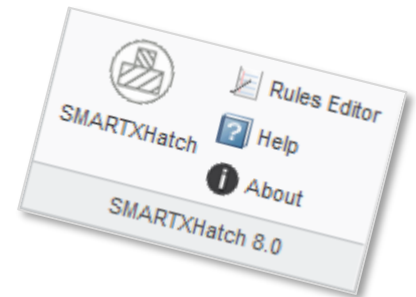

### SMARTXHatch provides:

- Fast and comfortable definition and update of cross hatchings
- Parameter based definition of hatching angle and space
- Reuse hatching from other views
- Preview window for resulting hatching

